

ENJOY YOUR VISIT

OUR SHOPS

PORTCULLIS GIFT SHOP

Located next to the Ticket Office, the shop offers an extensive range of quality gifts and souvenirs, including exclusive Edinburgh Castle merchandise, and traditional Scottish and Clan gifts.

CROWN GIFT SHOP

Located in Crown Square. Treat yourself to an extra-special memento of your visit. With a wonderful range of gifts, tapestries and exclusively designed jewellery and china.



WHISKY AND FINEST FOOD SHOP

Located near St Margaret's Chapel, a shop dedicated to offering the best of Scottish food and drink, ranging from whiskies and liqueurs to a delicious variety of Scottish sweet and savoury gifts.

Each purchase made in our retail outlets helps support Historic Scotland's conservation role. Your support is greatly appreciated and will help conserve our properties in the future.

OUR CAFÉS

REDCOAT CAFÉ

Found next to the One o'Clock Gun, a self-service café with spectacular views. With something for everyone, the café offers hot meals, light snacks, food on the go and a range of castle-baked delights. Teas, coffees and soft drinks are also available.



THE TEA ROOMS

Located in Crown Square. Come and enjoy a delicious traditional afternoon tea, complemented by a wide selection of luxury drinks and fresh handmade sandwiches and cakes. We also offer traditional Scottish fare, prepared and produced from the freshest local ingredients.

We fully cater for all dietary requirements. Please speak to a member of our friendly staff.

DISCOVER HISTORIC SCOTLAND

VISITOR INFORMATION

ASK OUR STAFF

Our friendly staff are on hand to help you explore some of Scotland's other historic attractions; and to answer any questions about Edinburgh Castle.



MEMBERSHIP

Historic Scotland membership offers unlimited free access to our 75 staffed sites, plus many other benefits, including quarterly magazine, discounts in our shops and special offers. Available here – ask at the ticket office.

FIND OUT MORE

If you have enjoyed your visit and would like to find out more, please visit www.edinburghcastle.scot. Or visit www.historicenvironment.scot to discover 5,000 years of Scottish history.

EDINBURGH CASTLE GUIDEBOOK

Our Official Souvenir Guide is the definitive guide to the buildings and history of Edinburgh Castle. Pick one up as a lasting souvenir of your visit. Available in various languages from all the castle shops and the ticket office.



Copyright © HES 2023
Illustrator Stephen Conlin/Pictu Ltd
All images © Crown copyright reproduced
courtesy of Historic Environment Scotland

ENGLISH

EDINBURGH
CASTLE



SITE
MAP



WELCOME TO
**EDINBURGH
CASTLE**



2

THE ONE O'CLOCK GUN

Gather at 1pm to see the master gunner fire the gun – every day except Sunday.



14

ST MARGARET'S CHAPEL

Take a quiet moment in St Margaret's Chapel, the oldest building in Edinburgh.



15

MONS MEG

Discover the firepower of this mighty siege cannon of the 1400s.



23

THE HONOURS OF SCOTLAND

Marvel at Scotland's glittering crown jewels and the historic Stone of Destiny.



24

THE GREAT HALL

Be amazed by the original hammerbeam roof in the Great Hall.



10

PRISONS OF WAR

Discover how prisoners of war lived here in the 1700s and 1800s.

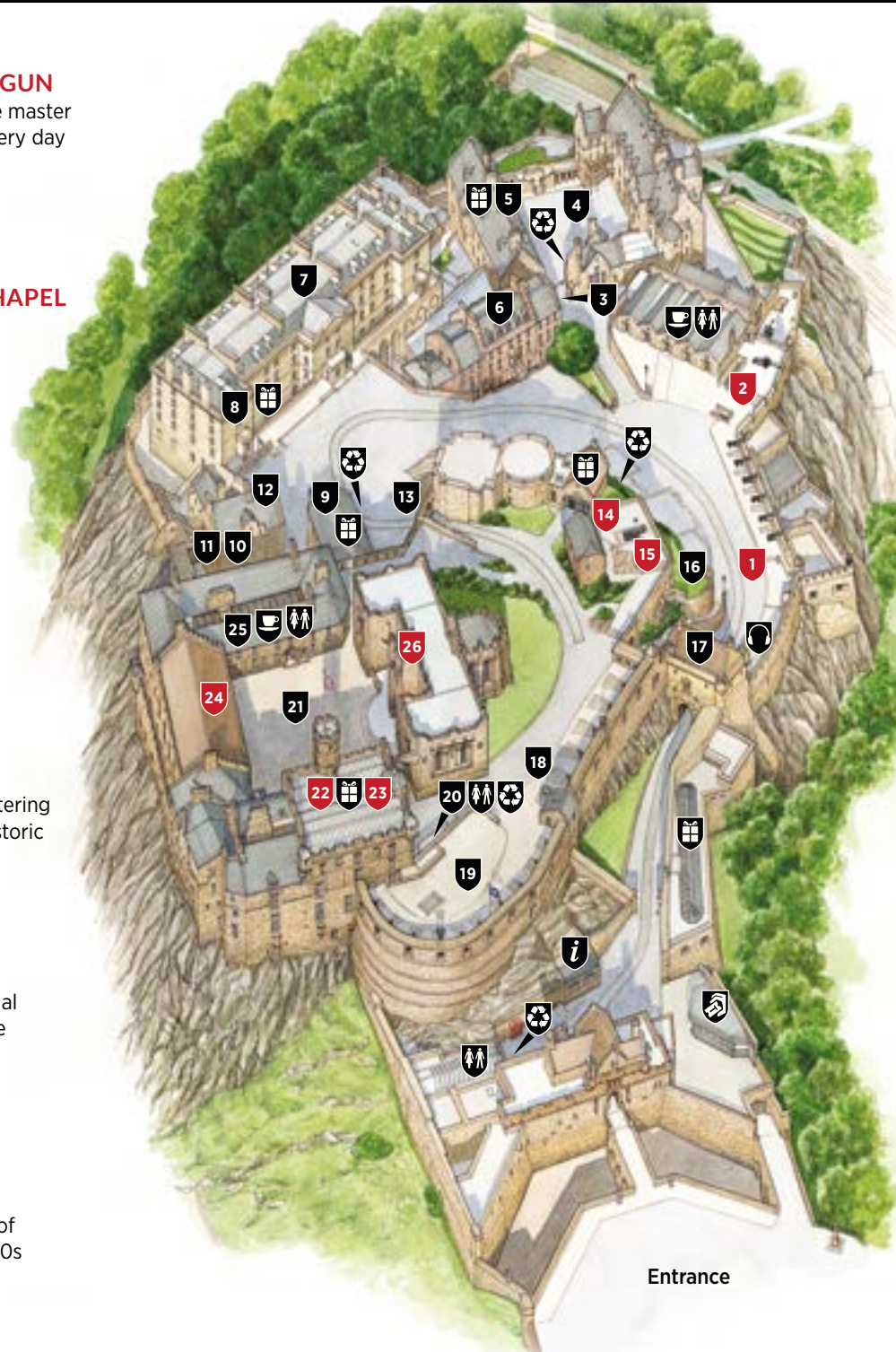

MAP KEY

Locations for the 8-stop audio tour are shown in red

- 1 Argyle Battery
- 2 One o' Clock Gun
- 3 Masons' Yard
- 4 Hospital Square
- 5 National War Museum
- 6 Governor's House
- 7 New Barracks
- 8 The Royal Scots Dragoon Guards Regimental Museum
- 9 Museum of the Royal Scots and the Royal Regiment of Scotland
- 10 Prisons of War
- 11 Dury's Battery
- 12 Military Prison
- 13 Foog's Gate, leading to Upper Ward
- 14 St Margaret's Chapel
- 15 Mons Meg
- 16 Dog Cemetery
- 17 Argyle Tower and Fight for the Castle exhibition
- 18 Fore Well
- 19 Half-Moon Battery
- 20 David's Tower
- 21 Crown Square
- 22 Royal Palace
- 23 The Honours of Scotland: the Scottish Crown Jewels
- 24 Great Hall
- 25 Queen Anne Building
- 26 Scottish National War Memorial

FACILITIES KEY

- Toilets
- Castle shop
- Café/Tea room
- Tickets
- Visitor information
- Recycling point

PLEASE NOTE

Smoking and vaping are not permitted within the castle.

AUDIO GUIDE

Purchased our audio guide online? Access it on your phone via your confirmation email.

If you want to hire one of our devices, please ask at the audio guide booth.



BSL TOUR

A filmed tour in British Sign Language is available. Go to edinburghcastle.scot/bsl-tour

FAMILY FUN

Download our Lion's Den Trail. Go to edinburghcastle.scot/family-trail