



GUIDING WITHIN EDINBURGH CASTLE

To assist with your visit we have prepared this useful guidance note, to ease congestion and to allow visitor movement through the site at all times. As guided parties, individuals or families, it is essential that all people who guide within the castle understand and comply with the guidelines set out below.

We would also ask that all guides remain courteous and polite at all times to other guides, members of the public and castle staff whilst visiting.

EDINBURGH CASTLE PERMITTED GUIDING AREAS (see map on the back of this sheet for details)

1 – Esplanade (see map area 1)

- This is the gathering point for each group.
- All guides should ensure that all admission tickets are given out here
- Guiding should not commence until after tickets are scanned and the group has entered the site through the Portcullis Gate
- Any visitors within a group who require toilet facilities should proceed to the toilets in Lower Ward. During this time we ask that the remainder of their group wait on the Esplanade for their return before progressing into the castle.

2 – Between the Randolph Plaque and Foogs Gate (Left Side of Road) (see map area 5)

- Guides may stop at any point they wish within this area, but please remember to remain on the **left side of the road**
- We ask that your groups refrain from moving over to look at the views, the cannons or the One O'clock Gun at this time.
- Please do not lead your group up the Lang Stairs, the route we have supplied is to ensure your guests get the best experience of the castle

3 – Right Hand side through Foogs Gate (see map area 6)

- Through Foogs Gate, a right turn and up a few steps will bring you to area 3
- Groups are not permitted to go to St Margaret's Chapel, with or without their guide. We ask that you inform your group that they may visit independently once your official tour is over

4 – Crown Square (see map area 7)

- Access to Crown Square and where you should finish the guided tour is via the West Side and South West corner of the Scottish National War Memorial (SNWM).
- Before leaving your group, please remind them of the restrictions on photography in the Scottish National War Memorial, the Crown Room and the Honours of the Kingdom Exhibition.
- To re-join you, please arrange for your group to meet and gather outside of the castle on the Esplanade at the end of their visit

IMPORTANT INFORMATION

- There must be **NO** guiding in any roofed buildings within the Castle and this includes:
 - Scottish National War Memorial
 - St Margaret's Chapel
 - Great Hall
 - Royal Apartments
 - Honours of Scotland Exhibition
 - Crown Room
 - Military Prisons and Prisons of War Exhibition
- Groups should be led through gateways as quickly as possible and we ask that there is no guiding whilst in queues, to ensure other visitors experience is not impacted
- It is the responsibility of you as the guide to keep your group together for the duration of the tour.
- Groups with children under the age of 16 must remain with an adult at **ALL** times.
- All guides are asked to show consideration to other guided groups on site, including whilst they are guiding. This includes the route taken by the Edinburgh Castle Official Guides during their guided tours.
- The use of the mobility vehicle is only available to those with mobility or health issues and should only be used when absolutely necessary

TECHNOLOGY TO ASSIST WITH GUIDING

Guides are permitted to use wireless transmission whisper systems (open audio load speakers are **not** permitted) and the guidelines above are still applicable. With emphasis on no guiding within any rooms, this includes where the guide stands outside of the room and guides their group remotely.

These guidelines are in place to ensure the enjoyment of all visitors to the site.



= Stopping / Guiding Area

Area 1 – Collection/Start Point/Guiding Area

Area 5 - Stopping / Guiding Area

Area 6 - Stopping / Guiding Area

Area 7 - Finish Point / Guiding Area



= Portcullis Gate



= Lower Ward Toilets

EDINBURGH
CASTLE

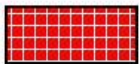
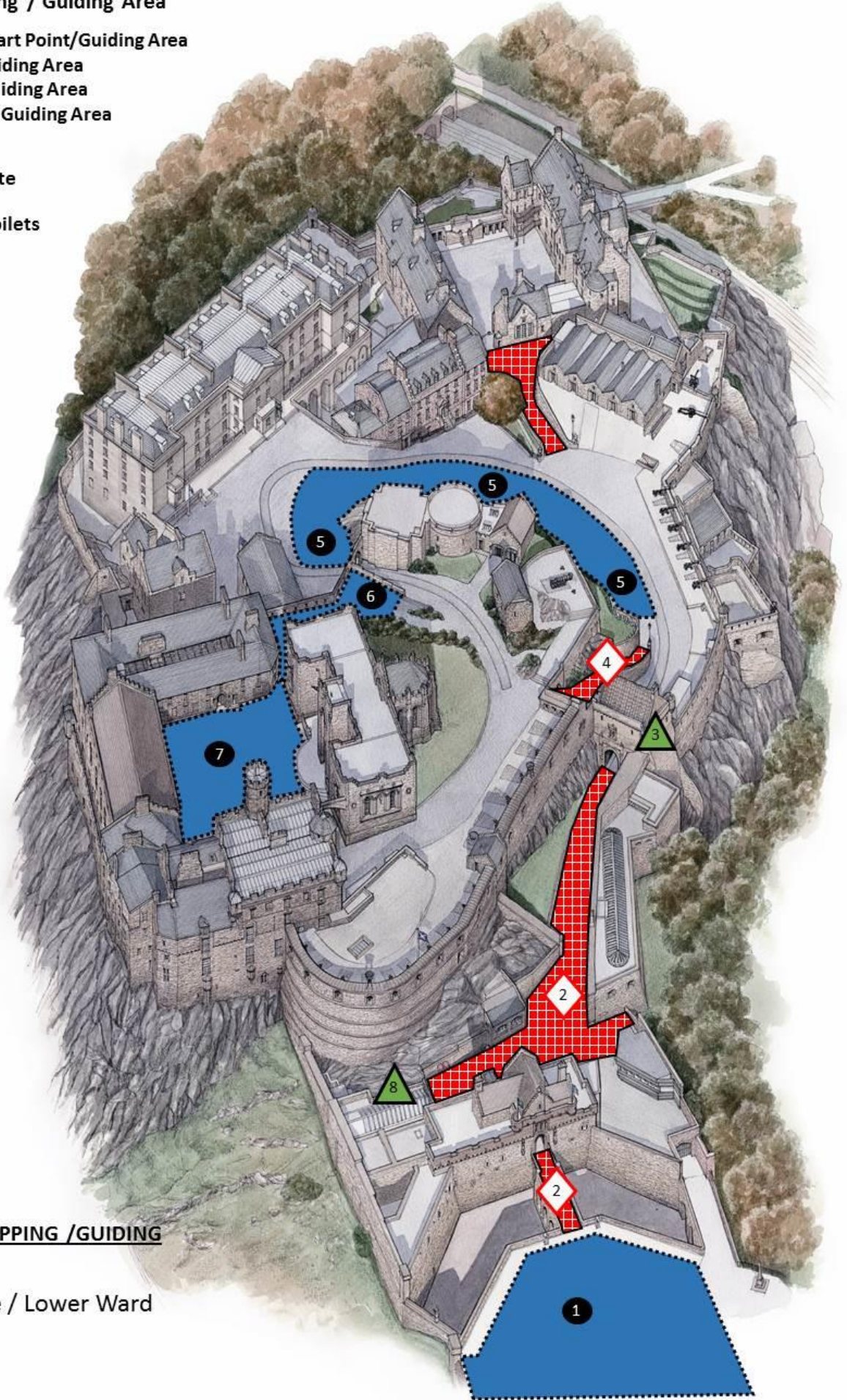

= NO STOPPING / GUIDING



= Draw Bridge / Lower Ward



= Lang Stairs